



PRODUCT FEATURES

- Body: EN GJL-250 Cast Iron
- Disc: Stainless Steel 304
- Stem: Stainless Steel 420
- Epoxy Powder Coating (Min 250microns)
- Seat Options: EPDM by default (Viton and NBR are optional)
- Easy gasket replacing
- 2 O-rings on the stem for better stem sealing
- Easy to install
- Can be operated with Pneumatic or Electrical actuators
- FAF3500 refers to wafer type FAF3600 refers to lug type butterfly valves

APPLICATIONS

FAF 3500 & FAF 3600 Butterfly Valves are generally used within potable water and heating (cold and hot water) systems. The valves are also suitable for food, chemical, petrochemical industry. The seats are not suitable for mediums having abrasive property (acidity or alkaline property).

EPDM

-20°C to +130°C

General Properties:

Resistance to sunlight, weathering and ozone. Poor resistance to petroleum oils and fuel. Good heat and compression set resistance.

Suitable for:

Less than 10% acids, inorganic and organic alcohols, alkaline salts and solutions, dry bulk, hot-cold water, steam Not suitable for Hydrocarbons

NBR

-20°C to +90°C

General Properties:

Good resistance to petroleum, hydrocarbons, fuels. Widely used with most oils, hydraulic fluids, alcohol. Poor resistance to sunlight, weathering and ozone.

Suitable for:

General Applications, Hydrocarbon Service, less than 40% Aromatics, Food&Beverage Applications.

VITON

-20°C to +200°C

General Properties:

Excellent temperature and chemical resistance. Excellent mechanical and physical properties, low compression set and low gas permeability.

Suitable For:

All Aromatic, Aliphatic and Halogenated Hydrocarbons
Not for Ketones, Ester or in combination with Hot Water and Oil.

DIMENSIONS AND PRODUCT DATA

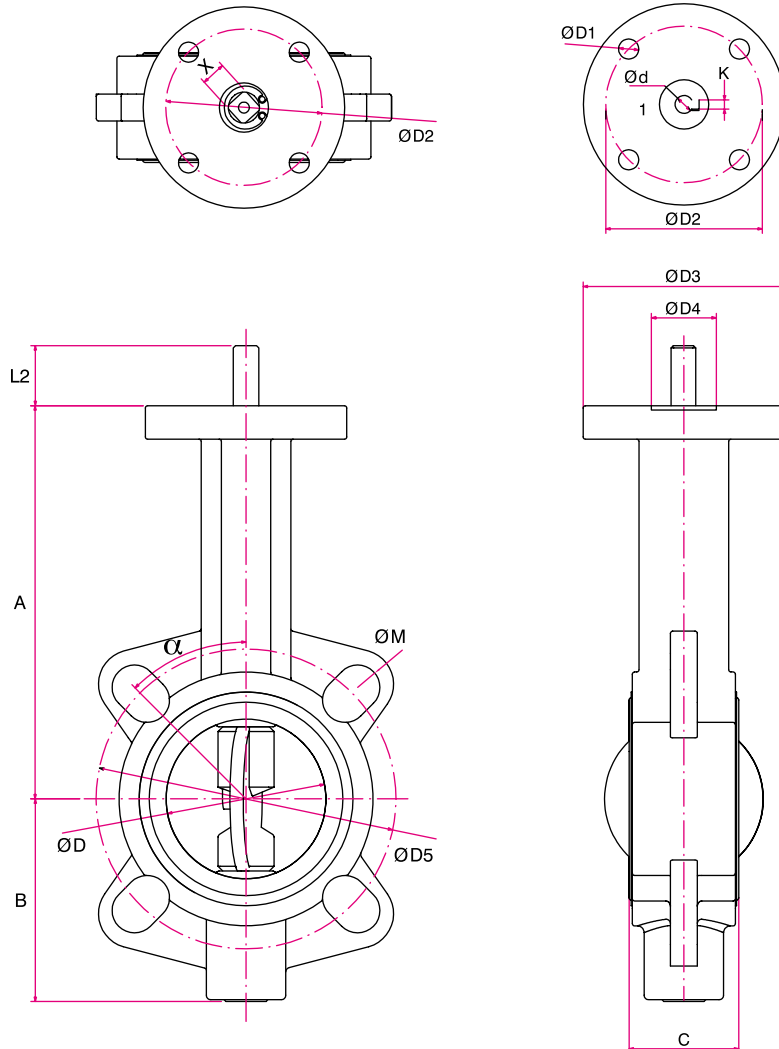

PN 10 / 16 LUG TYPE BUTTERFLY VALVE

DN	A	B	C	ØD	n-ØD1	ØD2	ØD3	ØD4	ØD5	ØM	X	L2	Ød1	K	α	Weight
40	138	75	33	45	4-9	50/70	90	22	110	19	11x11	30	-	-	45°	3,6
50	161	80	43	55	4-9	50/70	90	22	125	19	11x11	30	-	-	45°	4,5
65	175	91	46	70	4-9	50/70	90	22	145	19	11x11	30	-	-	45°	5,4
80	181	95	46	80	4-9	50/70	90	22	160	19	11x11	30	-	-	22,5°	5,6
100	200	115	52	101	4-9	70	90	24,5	180	19	14x14	30	-	-	22,5°	6,9
125	215	134	56	126	4-9	70	90	29,5	210	19	14x14	30	-	-	22,5°	10
150	225	138	56	151	4-9	70	90	29,5	240	23	17x17	30	-	-	22,5°	12
200	241	174	60	200,5	4-11	102	125	35,5	295	23	17x17	30	-	-	15°	14,5
250	296	198	68	250	4-11	102	125	39,5	355	28	22x22	30	-	-	15°	32,3
300	336	234	78	300,5	4-11	102	125	41	410	28	22x22	30	-	-	15°	44,6
350	370	284	78	340	4-13	125	150	72	470	28	22x22	46	-	-	11,25°	66
400	400	310	88	400	4-18	140	175	73	525	31	27x27	46	-	-	11,25°	104
450	422	328	104,6	440	4-18	140	175	102	565	-	-	52	39	10	11,25°	140
500	490	390	127	500	4-22	165	210	135	650	34	-	48	48	14	9°	157
600	575	456	154	600	4-22	165	210	135	770	37	-	48	48	14	9°	222

ITEMS AND MATERIALS

- 1 Body: EN-GJL 250 Cast Iron
- 2 Stem: Stainless Steel 420
- 3 Disc: Stainless Steel 304
- 4 Bottom Screw Gland: Stainless Steel 420
- 5 O-Rings: EPDM
- 6 Seat: EPDM (NBR and VITON are optional)
- 7 Limiting Plate: St37 Steel
- 8 Bolts: Galvanized Steel
- 9 Nuts: Galvanized Steel