

DUAL PLATE CHECK VALVE (FAF 2350)



PRODUCT FEATURES

- Body, GG-25 Cast Iron.
- Disc, Stainless Steel SAE (AISI) 304.
- Disc gasket, EPDM.
- Easy to install.

APPLICATIONS

Hot and cold water systems and industrial applications

OPERATING TEMPERATURE

130°C 266°F for EPDM O-Ring,

DUAL PLATE CHECK VALVE (FAF 2350)

DIMENSIONS AND PRODUCT DATA

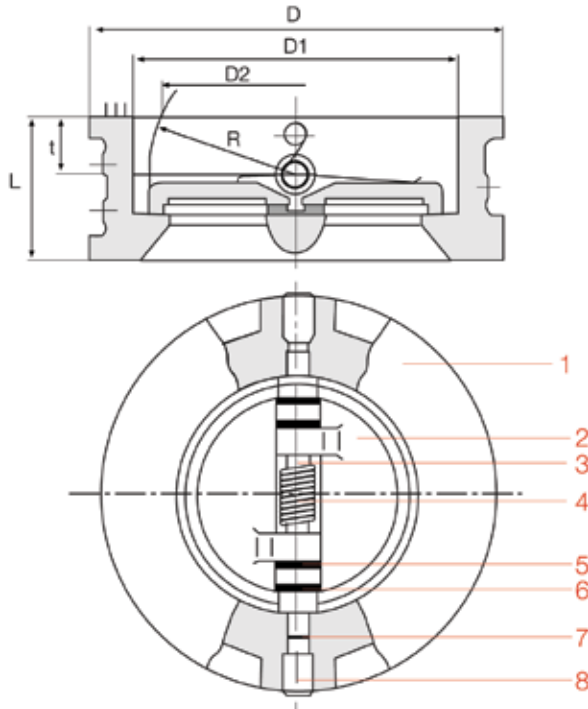

ITEMS AND MATERIALS

1. Body / GG 25 cast iron
2. Disc / Stainless Steel
3. Stem / Stainless Steel
4. Spring / Stainless Steel
5. Washer / PTFE
6. Washer / PTFE
7. Gasket / EPDM
8. Hex Nut / A193A

FAF 2350

DUAL PLATE CHECK VALVE

| DN | DIMENSIONS | | | | | | PRODUCT DATA |
|-----|------------|-----|-----|-----|-------|------|--------------|
| | Ømm | D | D1 | D2 | L | R | t |
| 40 | 92 | 55 | 37 | 43 | 23 | 17,5 | 0.75 |
| 50 | 107 | 65 | 40 | 43 | 27 | 18.4 | 1.5 |
| 65 | 127 | 80 | 60 | 46 | 35 | 19.8 | 2.10 |
| 80 | 142 | 94 | 70 | 64 | 42 | 27.7 | 3.30 |
| 100 | 162 | 117 | 88 | 64 | 50 | 27.7 | 4.22 |
| 125 | 192 | 145 | 115 | 70 | 64 | 30.3 | 7.00 |
| 150 | 218 | 171 | 134 | 76 | 77 | 31.6 | 9.00 |
| 200 | 273 | 224 | 182 | 89 | 102.5 | 32.9 | 15.00 |
| 250 | 328 | 265 | 220 | 114 | 125 | 50.5 | 26.5 |
| 300 | 378 | 310 | 260 | 114 | 146 | 43.3 | 37 |
| 350 | 443 | 356 | 356 | 184 | 167 | 45,5 | 55 |
| 400 | 488 | 410 | 410 | 140 | 190 | 52 | 80 |

MATERIAL PROPERTIES

| MATERIAL TYPE | MATERIAL PROPERTY |
|----------------------------|--|
| GG 25 Cast Iron | Tensile strength = 250-350 N/mm ² Hardness = Max. 250 Brinell (BHN) |
| GGG 40 Ductile Iron | Tensile strength = 400-550 N/mm ² Hardness = 135 - 185 Brinell (BHN) |
| Stainless Steel DIN 1-4086 | C = 0.9 - 1.3 Si Max.=2 Mn Max.= 1 Cr = 27 - 30 |
| Stainless Steel SAE-304 | C max = 0.08 Si Max.=1 Mn Max.=2 Cr = 18-20 Ni = 8 - 10.5 |
| Stainless Steel SAE-316 | C max = 0.08 Si Max.=1 Mn Max.=2 Cr = 16-18 Ni = 10- 14 |
| PTFE | Density= 2.13-2.23 gr/cm ³ Tensile strength = 250-300 kg/cm ² |
| PTFE (25 % Carbon) | Operating Temperature =-85°C / +200°C 392°F Density= 2.1-2.2 gr/cm ³ Tensile strength = 165-170 kg/cm ² |
| Graphitic Ring | Graphite purity = %98 Density= min.1.6 gr/cm ³ |
| St 37 | C = < = 0.2 P Max.= 0.06 S Max.= 0.05 Tensile strength = 360-440 N/mm ² |
| Steel (1030) | C = 0.30 P Max.= 0.06 S Max.= 0.06 Tensile strength = 490 N/mm ² |